



Main Features:-

- ◆ Needle Valve
- ◆ 1/4" to 2" PN3000
- ◆ Threaded ends ASME B1.20.1 (NPT)
- ◆ 1/4"-1/2" = 260 °C. 3/4"-1 1/4" = 240 °C. 1 1/2" - 2" = 200 °C

*Temperature and pressure determined by valve body, seat etc.

Suitable Applications & Approvals:



HVAC



OIL



GAS



INDUSTRY



SERIES: 80237

MANUFACTURER: **GENEBRE**

VALVE MATERIALS

| ITEM | SECTION | MATERIAL | ADDITIONAL INFO / OPTIONS |
|------|--------------|--------------------|---------------------------|
| 1 | Body | ≤ 1": ASTM A479-04 | ≥ 1 1/4": ASTM A182 F316 |
| 2 | Bonnet | AISI 316 | n/a |
| 3 | Nut | AISI 316 | n/a |
| 4 | Needle | A182 F6 | Nitrogen Treatment |
| 5 | Stem | ASTM A182 F316 | n/a |
| 6 | Stem Packing | PTFE + Graphite | n/a |
| 7 | Packing Nut | SS 316 | n/a |
| 8 | Handwheel | Cast Iron | Painted |
| 9 | Nut | SS 304 | n/a |
| 10 | Washer | SS 304 | n/a |

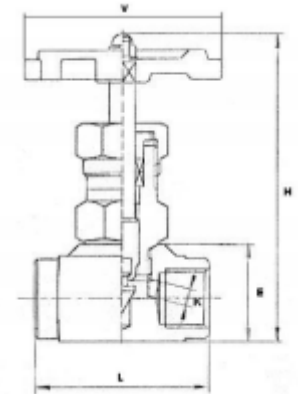
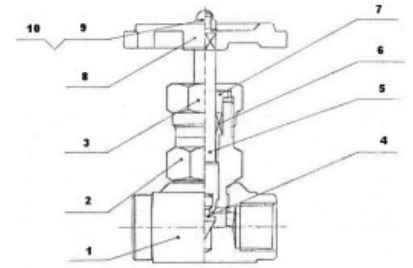

| REF | SIZE | PN | E | H | L | K | V | Kg |
|----------|--------|------|----|-----|-----|----|-----|-------|
| 80237-02 | 1/4" | 3000 | 25 | 85 | 50 | 3 | 63 | 0.26 |
| 80237-03 | 3/8" | 3000 | 30 | 100 | 55 | 4 | 63 | 0.36 |
| 80237-04 | 1/2" | 3000 | 34 | 115 | 60 | 6 | 72 | 0.53 |
| 80237-05 | 3/4" | 3000 | 40 | 120 | 70 | 8 | 72 | 0.76 |
| 80237-06 | 1" | 3000 | 45 | 138 | 75 | 9 | 80 | 1.175 |
| 80237-07 | 1 1/4" | 3000 | 57 | 165 | 90 | 11 | 100 | 1.85 |
| 80237-08 | 1 1/2" | 3000 | 67 | 185 | 100 | 15 | 120 | 2.9 |
| 80237-09 | 2" | 3000 | 78 | 195 | 120 | 18 | 140 | 4.7 |

T +44 (0)1386 552369

W www.allvalves.co.uk

E sales@allvalves.co.uk

F +44 (0)1386 554227





Genebre are a global brand of industrial valves with large stocks held for fast delivery on various type of valves, sizes, end connections and materials.

SERIES: 80237

TORQUE / Kv VALUES / DIMENSIONS

| REF | SIZE | Kv | KV VALUES: |
|----------|--------|------|---|
| 80237-02 | 1/4" | 0.25 | - The Kv values (M3 per hour) is the flow of water at a temperature of 5C to 30C (41F to 86F) at p of 1 bar - For further information, please email sales@allvalves.co.uk |
| 80237-03 | 3/8" | 0.36 | |
| 80237-04 | 1/2" | 0.47 | |
| 80237-05 | 3/4" | 0.95 | |
| 80237-06 | 1" | 1.1 | |
| 80237-07 | 1 1/4" | 1.6 | |
| 80237-08 | 1 1/2" | 4.76 | |
| 80237-09 | 2" | 5.36 | |

PRESSURE TEMPERATURE RATING

GENEBRE

Genebre is a leading company and world reference in fluid control and high-quality taps. They control all the creation processes, responding to the specific needs of each market: from the initial concept and design of the product to the production and commercialization.

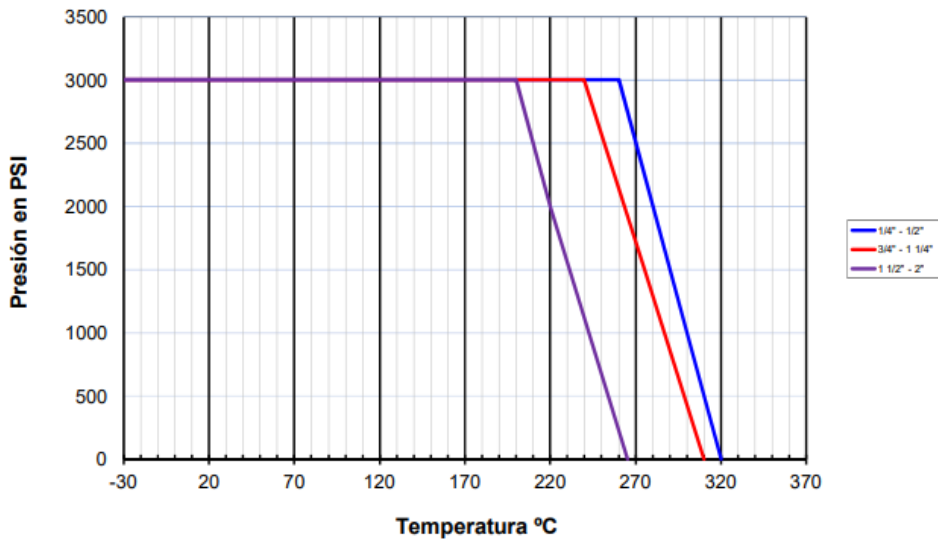

ALL VALVES

Offering a full range of actuated valve packages, manual valve range, pipe fittings and pumps, we have a product for all your requirements. As an ISO 9001-2015 Quality Approved and certified company, All Valves offer a quality service from pre-sale to post sale. Shipping millions of pounds in value of manual valve and actuated valve packages all over the world since its formation, All Valves are a trusted valve and actuator supplier to many companies all over the world. Working with the leading brands in most industries.



T +44 (0)1386 552369

E sales@allvalves.co.uk

W www.allvalves.co.uk

F +44 (0)1386 554227